



DEVICE FOR AUTO-INSERTING AND EXTRACTING AN INTERNAL BAG FOR THE COLLECTION OF WASTE IN PATIENTS WITH DISPOSAL STOMA SURGERY

TECHNOLOGY OFFER



COMPETITIVE ADVANTAGES

- ✓ **Market:** condition suffered between 2 and 4 per thousand adults in Western countries.
- ✓ Great increase of the patient's quality of life compared to what it is offered by current devices (external bags, stoma plugs, colostomy irrigation).
- ✓ Easy to use, both by health personnel and patients.
- ✓ **Adaptable device:** Size and shape

INNOVATIVE ASPECTS

- ✓ The pouch or bag of the device is placed inside the intestine, thus providing a better acceptance of the corporal change and greater comfort in patients with disposal stoma.
- ✓ The pouch or bag of the device does not come into contact with the waste, avoiding the irritation of the skin around the stoma and greatly facilitating its manipulation.
- ✓ The attachment means to the body do not include adhesive elements to the patient's skin, which helps to avoid skin disorders, although the device can also be attached, unmodified, to the commercial adhesive discs which are currently used for holding of external bags. It also has the possibility of self-attaching to the stoma through a lever mechanism.
- ✓ It can be used permanently or for periods of time.
- ✓ The device can be adapted to different stoma sizes through its customization by additive manufacturing techniques and parametric design.

PATENTS

ES patent applied.
In time to seek international patent protection.

TYPE OF COLLABORATION

Licence agreement.

ABSTRACT

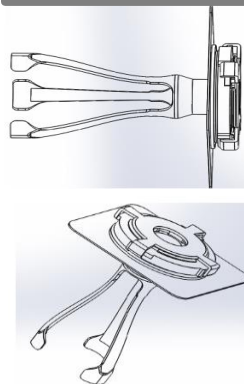

The present technology relates to a self-expanding device for placing a bag inside the body, which collects waste of a patient who has undergone an intervention as a colostomy or ileostomy. It is an alternative solution to the already known external colostomy bags. The invention comprises a pouch or bag inserted inside a patient's body for collecting the waste; a self-expander device on said pouch, which inserts and expands the bag inside the patient's body and is attached to the patient's body; and means for attaching the self-expander device to the patient's body.

Principal Researchers

- José Manuel Sierra Velasco
- José Ignacio Rodríguez García

Departments

- Construction and Manufacturing Engineering
- Surgery and Medical Surgical Specialities

E.mail

otri@uniovi.es